

ECLIPSE PREMIUM TENSION FABRIC POP UP DISPLAY

Applies for all models: 5ft straight, 8ft straight & curved, 10ft straight & curved



NOTE: 5ft straight shown in example



1 Remove frame and graphic from nylon bag.



2 Ensure "adjustable feet" of frame are on the floor. Pull up display into upright position.

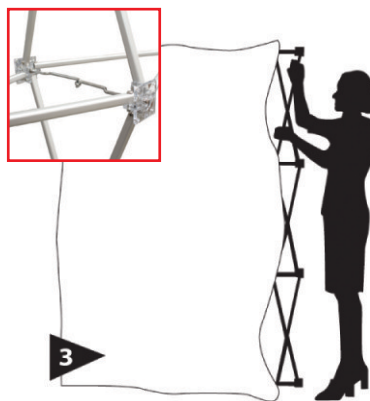

3 Lock all hooks between front and back hubs.

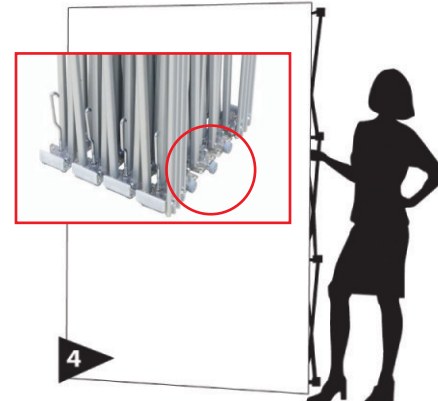

4 Adjust leveling feet for desired angle. Ready pop display can now easily be moved into position.



5 OPTIONAL
Attach lights to top of frame by sliding the plastic "x blocks" under the frames cross sections.

WARNING: Damage to frame from mishandling is not covered under the warranty. **DAMAGE COULD OCCUR FROM FORCING FRAME CLOSED.** To avoid damage, **MAKE SURE** to separate end caps & disconnect **ALL** frame hooks **BEFORE** trying to collapse the frame. If all hooks are 'unlatched' the frame will want to automatically expand down and close for travel and storage.

How to install or replace graphics

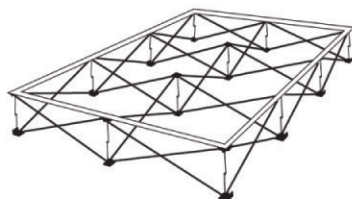

1 Assemble frame and lay flat on its back. Remove existing graphic.

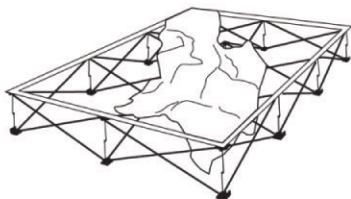

2 Starting at one corner, attach velcro on the graphic to velcro on the frame. NOTE: Velcro on the graphic should extend approx. 1/4" - 1/2" beyond velcro on the frame (it should not be flush).

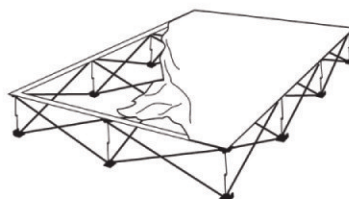

3 Working in a continuous direction around the frame, attach the rest of the graphic. Make sure the graphic is pulled taut while attaching the velcro.



4 If needed, adjust velcro for taut fit.

How to install optional podium graphic kit

1 The Oval Hard Shipping case is optional and must be purchased for the ultimate in shipping protection.



2 Slide printed fabric graphic wrap over top of case and secure underneath bottom of case.



FINISHED CASE-TO-PODIUM