

# Coyote popup accessory instructions - Internal Shelf

## Assembly

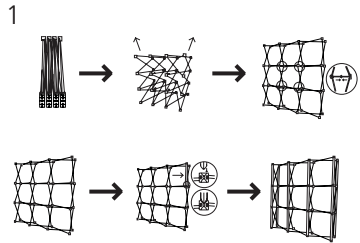

Assemble Coyote frame as directed on page 9.

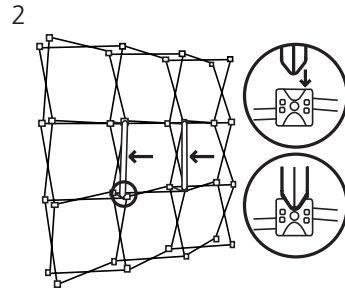

Apply magnetic channel bars to frame.

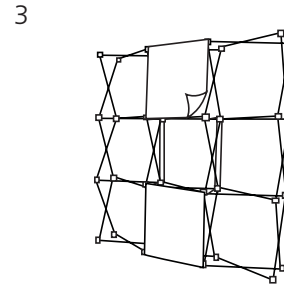

Attach top and bottom graphic panels to frame.

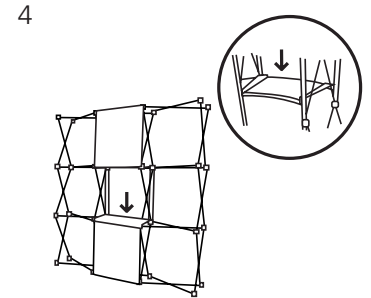

Place black plastic panel in middle of frame on the bottom.

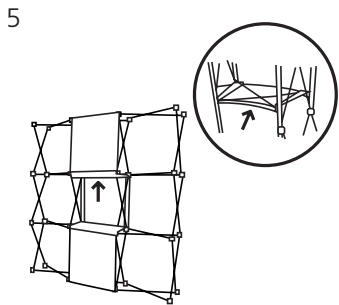

Insert a black plastic panel into the top of middle frame and hold in place.

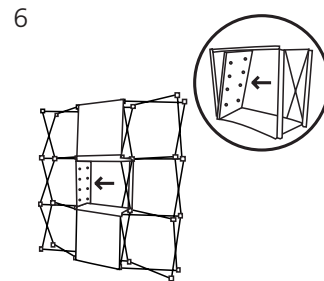

While holding top siding in place, insert left vertical siding.  
\*Make sure the sides have grooves for shelf.

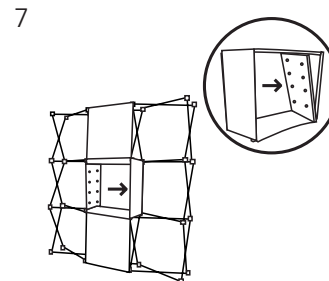

Continue holding the top shelf and insert right side. \*Make sure the sides have grooves for shelf.

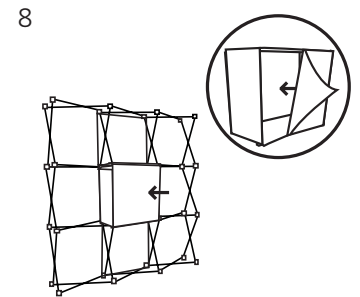

Place graphic panel on the back of the frame, behind middle opening to enclose the space.

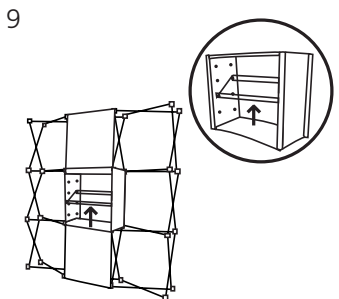

Insert clear shelving using the grooves on black plastic panels to hold in place.

## Graphic Application

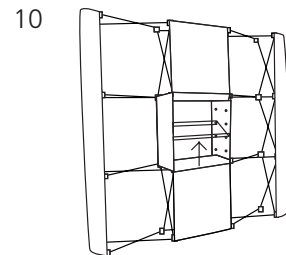

Start attaching graphic panels, doing the end caps first then center graphics.



Display is complete.

## Optional Light Kit

12 **Includes:**  
2 puck lights, power cord & power adapter

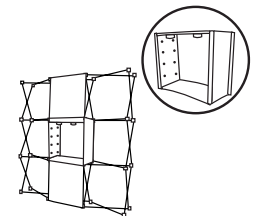

Lights will come pre-installed in top of shelf kit.