

**Congratulations on the purchase of your
1UP Table Top Pop Up Display.**

affordable
exhibit
displays inc

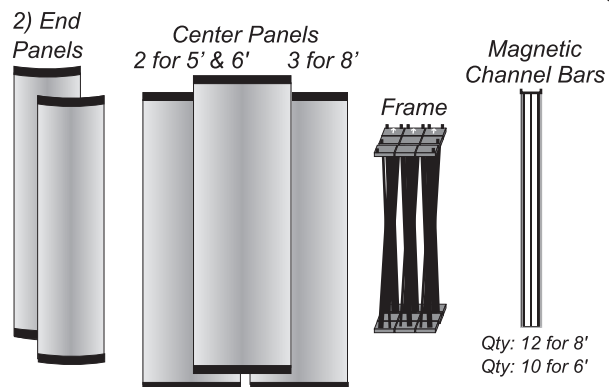

Quick Directions

- 1 - Place frame on floor or table and expand frame upward
Secure frame with magnetic locking bars
- 2 - Install magnetic channel bars
- 3 - Magnetically attach Center Panels then End Caps

1

Expand frame upward until
MAGNETIC LOCKING BARS make
contact, this will hold the frame in
place to install the magnetic channel
bars in step 2.

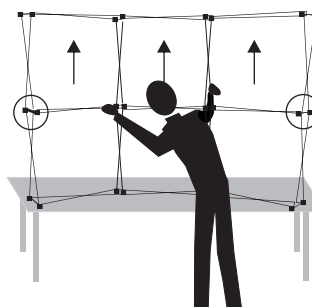

*Magnetic
locking bars

*The quantity and location
of Magnetic Locking Bars
will vary depending on
size of display frame

To release the Magnetic Locking Bars place one
hand on each side of locking bar and in a quick
motion pull apart. Be sure all Magnetic Bars are
release before attempting to lower frame.

2

Channel Bar Installation

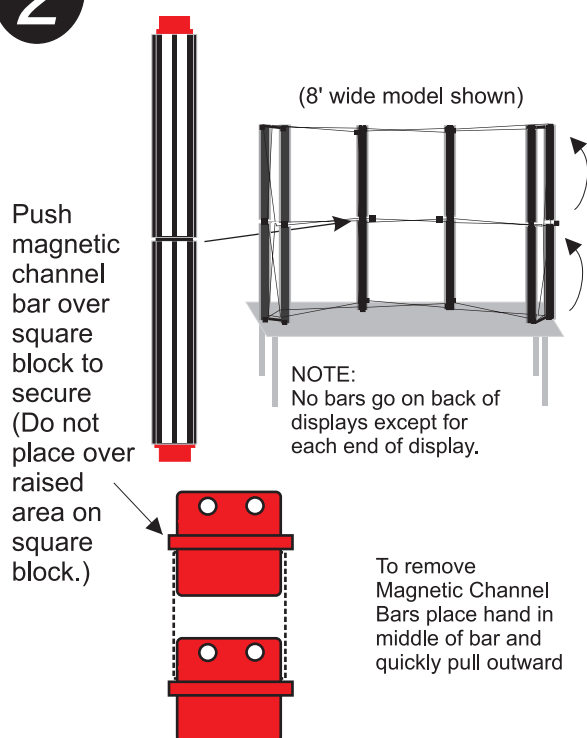

3

Panel Installation

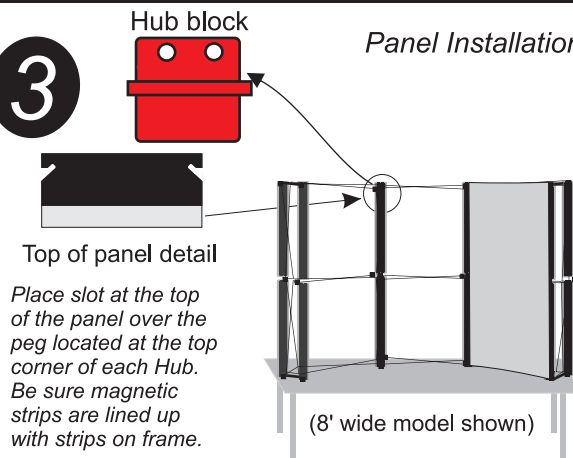

CAUTION

Store all components at room temperature before set up. Make sure to disengage locking bars **before** collapsing frame for storage or damage could occur. Do not roll fabric panels smaller than 10" in diameter.

*Note: Display shown is 8' Table Model.

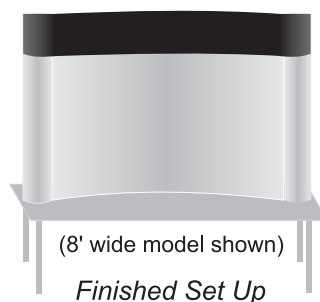

MADE IN
USA

307 Route 202, Greene, ME 04236

1.800.723.2050

AffordableDisplays.com