

Wave Flexi-Link modules

Total system heights

Midi 229 cm / 90.2"

Starter kit IS-W-82-S

Extension kit IS-W-82-E

Maxi 249 cm / 98.0"

Starter kit IS-W-83-S

Extension kit IS-W-83-E



Starter kit complete with:
2 post sets, 2 feet, 1 Wave Flexi-Link,
2 sets corner trim, 1 set kicker and hanger

Extension kit complete with:
1 post set, 1 foot, 1 Wave Flexi-Link,
1 set kicker and hanger

Magnetic tape for graphic panels are not included.

Accessories

Padded case on wheels

Holds up to a 6 section Wave system.
Item IS-TC-01-MB



Small graphic tube
to be attached to frame case
Holds up to 6 panels,
Item IS-0850-RTS-S-MB



Large graphic tube,
with handle and shoulder strap.
Holds up to 9 panels,
Item IS-0850-RTB-S-MB

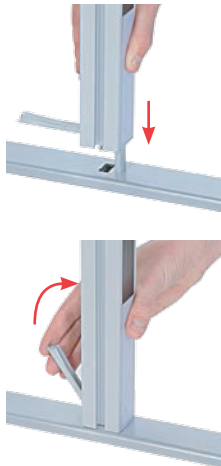

1 Begin by attaching the foot on the base post. Mount the stem on the foot into the front slot and lock the FASTclamp.



2 Insert the Wave Flexi-Link in the groove on the base post and push down.



3 Mount the extension post on top of the base post.



4 If you want Maxi height, add a short extension post before you mount the top post.



5 Complete the post with a top post section with the plastic top hub.



6 Follow these same steps for the second post in the starter module. The starter kit is now ready for a graphic panel.



7 Now you can add an Extension Module onto the starter section just built. Create a foot+base post+Flexi-Link assembly as before, then insert the link into a base post of the starter module and press down into place.



8 Follow the procedures shown above to build the new post to the height of the starter section. Add more modules as desired.

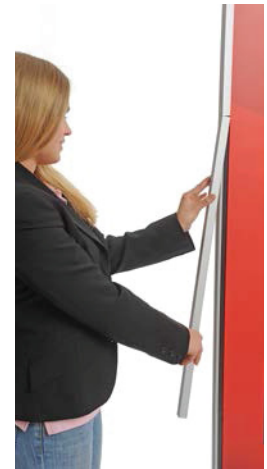

9 When the Wave wall is complete, finish each end by placing a set of 3 corner trims on the exposed magnets of the post.

Corner trims (see reverse side)